

DOOR FURNITURE	93
BATHROOM FITTINGS	94
IRONMONGERY ACCESSORIES	95
DOOR CLOSERS	97
EMERGENCY EXIT HARDWARE	98
LOCKS & CYLINDERS	99
HINGES	101
SHELVING SOLUTIONS	101
ACCESS CONTROL	102

SECTION 08 IRONMONGERY

This section shows some popular lines of door furniture, plus a range of standard ironmongery products. If you can't find the design or types of product you need, give us a call.

**Carlisle
BRASS**

Heritage Brass
SOLID BRASS DOOR FURNITURE

HOPPE® 
Handle of excellence.



DOOR FURNITURE

A guide to finishes is available on page 94.

ALUMINIUM LEVER FURNITURE

Edinburgh 189N Series

DESCRIPTION	FINISHES
Concealed fix rectangular plate	SAA / GAA
Face fix rectangular plate	SAA



Paris 138L Series Ø19mm

DESCRIPTION	FINISHES
Concealed fix rectangular plate	SAA / GAA
Concealed fix radius plate	SAA / GAA
Face fix 160 x 160mm plate	SAA / GAA
Face fix 160 x 64mm plate	SAA / GAA



GRADE 316 STAINLESS STEEL LEVER FURNITURE

750 Series Disabled Lever Furniture

DESCRIPTION	FINISHES
Round rose	SAA
Concealed fix rectangular plate	SAA



AR361 Series Ø20mm

DESCRIPTION	FINISHES
Round rose 6 or 8mm	SSS / PSS
Concealed fix rectangular plate	SSS / PSS



BRASS LEVER FURNITURE

Dubay M107 Series

DESCRIPTION	FINISHES
Victorian Straight	PB / CP / SCP
Face fix rectangular plate (Latch)	PB / CP / SCP
Face fix rectangular plate (Lock)	PB / CP / SCP



Leon M1720 Series

DESCRIPTION	FINISHES
Victorian Scroll	PB / CP / SCP
Round rose	PB / CP / SCP
Face fix rectangular plate (Latch)	PB / CP / SCP
Face fix rectangular plate (Latch)	PB / CP / SCP
Face fix shaped plate	PB / CP / SCP



Memphis M163 Series

DESCRIPTION	FINISHES
Georgian	PB / CP / SCP
Face fix rectangular plate (Latch)	PB / CP / SCP
Face fix rectangular plate (Latch)	PB / CP / SCP



BRASS & NYLON LEVER FURNITURE

Paris M138 Series

DESCRIPTION	FINISHES
Round rose	PB



Paris K138 Series

DESCRIPTION	FINISHES
Steel Corded Nylon	11 RAL Colours
Round rose	11 RAL Colours
Concealed fix rectangular plate	11 RAL Colours
Concealed fix radius plate	11 RAL Colours



PULL HANDLES

Pull handles are available in a wide variety of diameters, lengths, applications and finishes.

Aluminium Straight Pull Handles

CODE	SIZE Ø (MM)	LENGTH (CENTRES MM)	FIXING	FINISH
AR202	(19), 20	150, 225, 300, 425, (600)	CF	SAA
AR203	(19), 20	150, 225, 300, 425, (600)	BF	SAA
AR204	(19), 20	150, 225, 300, 425, (600)	BB	SAA
AR222	22	150, 225, 300, 425, 600	CF	SAA
AR223	22	150, 225, 300, 425, 600	BF	SAA
AR224	22	150, 225, 300, 425, 600	BB	SAA



Aluminium Straight Pull Handles

Screw fix on plate.

CODE	SIZE Ø (MM)	LENGTH (CENTRES MM)	FIXING	FINISH
AR205	19	150, 225, 300	FF	SAA
AR225	22	150, 225, 300	FF	SAA

Grade 316 Stainless Steel

Straight pull handles.

CODE	SIZE Ø (MM)	LENGTH (CENTRES MM)	FIXING	FINISH
AR316	19, 22	150, 225, 300, 425, 600	CF, BF, BB	SSS, PSS

Grade 3617 Stainless Steel

"T" Bar pull handles.

CODE	SIZE Ø (MM)	LENGTH (CENTRES MM)	FIXING	FINISH
AR3617	19	225, 300	BF, BB	SSS, PSS

Brass Straight Pull Handles

CODE	SIZE Ø (MM)	LENGTH (CENTRES MM)	FIXING	FINISH
AR402	19	150, 225, 300, 425, 600	CF	PB, CP, SCP, PVD
AR403	19	150, 225, 300, 425, 600	BF	PB, CP, SCP, PVD
AR404	19	150, 225, 300, 425, 600	BB	PB, CP, SCP, PVD

Nylon Straight Pull Handles

CODE	SIZE Ø (MM)	LENGTH (CENTRES MM)	FIXING	FINISH
AR602	23	160	CF, BF, BB	x11 RAL Colours
AR602	34	220, 300	CF, BF, BB	x11 RAL Colours

Pull handles on Rose of 400mm centres or greater satisfy the requirements of BS8300 and Approved Document "M" of the Building Regulations.

Guide to Finishes

- BL Black
- CP Chrome Plate
- F9 Darker Anodised Aluminium
- GAA Gold Anodised Aluminium
- GE Gold
- PAA Polished Anodised Aluminium
- PB Polished Brass
- PSS Polished Stainless Steel
- PVD Physical Vapour Deposition
- SAA Satin Anodised Aluminium
- SB Satin Brass
- SCP Satin Chrome
- SE Silver
- SSS Satin Stainless Steel

RAL Colours

- RAL1004 Golden Yellow
- RAL5002 Cobalt Blue
- RAL7043 Flint Grey
- RAL9016 Diamond White
- RAL3003 Red Rouge
- RAL5003 Midnight Blue
- RAL7506 Manhattan Grey
- RAL9017 Black (Ebony)
- RAL3005 Claret
- RAL6016 Green (Viridian)
- RAL8017 Brown (Sienna)

Fixing

- BB Back-to-back fix
- BF Bolt fix
- CF Concealed fix
- FF Face fix



AR205



316



AR402



AR602

BATHROOM FITTINGS

CODE	DESCRIPTION	FINISHES
AR763	Folding Grab Rail	White & SSS
AR764	Backrest	White & SSS
AR765	Grab/Towel Rail 34mm x 600mm	White & SSS

DOC-M Bathroom Packs

The items listed above are available in "DOC-M" Packs.

Part Number AR-767 includes 1 No AR763 Folding Grab Rail, 1 No AR764 Backrest and 3 No AR765 Grab Rails.

Part Number AR-768 includes 1 No AR763 Folding Grab Rail, 1 No AR764 Backrest and 4 No AR765 Grab Rails.



AR763

MORE PRODUCTS AVAILABLE! CONTACT US TODAY IF YOU CAN'T FIND WHAT YOU'RE LOOKING FOR

IRONMONGERY ACCESSORIES

ACCESSORIES

CODE	DESCRIPTION	FINISHES
AR212	70mm Concealed Fix Door Stop on Rose	SAA
AR213	70mm Secret Fixing Door Stop	SAA
AR122	Oval Shielded Door Stop	SAA
AR214	Floor Mounted Door Stop	SAA
AR162A	35mm Black Rubber Door Stop	SAA
AR206	Cylinder Pull for Rim, Euro or Oval Cylinder	SAA
AR135A or AR135B	100mm or 125mm Strip Pattern Hat & Coat Hook	SAA
AR136	90mm Strip Pattern Hat & Coat Hook, 90° Angle	SAA
AR218	90mm Strip Pattern Buffered Hat & Coat Hook, 90° Angle	SAA
AR217	Heavy Pattern Hat & Coat Hook	SAA
AR137	Strip Pattern Wardrobe Hook	SAA
AR219	Heavy Pattern Wardrobe Hook	SAA
AR113A or AR113B	250mm or 300mm Sprung Flap Letter Plate	SAA
AR114A or AR114B	250mm or 300mm Internal Letter Tidy	SAA
AR132A or AR132B	19 x 150mm or 200mm Flush Bolt	SAA
AR224A, C or D	75 x 305mm, 350mm or 475mm Square Corner Finger Plate	SAA
AR224B	75 x 305mm Radiused End Finger Plate	SAA
AR225	Kick Plate (Cut to Order)	SAA
AR140	50mm Face Fix Numerals 0 to 9	SAA
AR334A	76mm Concealed Fix Door Stop on Rose	SSS or PSS
AR334B	76mm Secret Fix Door Stop	SSS or PSS
AR334E	Oval Shielded Door Stop	SSS or PSS
AR334F	Dome Shaped Door Stop	SSS or PSS
AR306	Cylinder Pull for Rim, Euro or Oval Cylinder	SSS or PSS
AR317	120mm Strip Pattern Hat & Coat Hook	SSS or PSS
AR318	120mm Strip Pattern Buffered Hat & Coat Hook	SSS or PSS
AR319	63mm Wardrobe Hook	SSS or PSS
AR326B or AR326A	20 x 200mm or 250mm Flush Bolt	SSS or PSS
AR324A or C	75 x 300mm or 330mm Square Corner Finger Plate	SSS or PSS
AR324B	75 x 300mm Radiused End Finger Plate	SSS or PSS
AR324P	75 x 300mm Square Corner Finger Plate (Engraved PUSH)	SSS or PSS
AR325	Kick Plate (Cut to Order)	SSS or PSS
AR340-FF	75mm Face Fix Numerals/Letters 0 to 9 & A to D	SSS or PSS
AR427B	76mm Concealed Fix Door Stop on Rose	Brass PVD, CP, SCP
AR427C	76mm Secret Fix Door Stop	Brass PVD, CP, SCP
AR427D	Oval Shielded Door Stop	Brass PVD, CP, SCP
AR427A	Dome Shaped Door Stop	Brass PVD, CP, SCP
AR406	Cylinder Pull for Rim, Euro and Oval Cylinders	Brass
AR528 or AR529	Georgian or Victorian Cylinder Pull for Rim Cylinder	PB, Brass PVD, CP, SCP
AR418	Buffered Hat & Coat Hook	PB
AR534	Hat & Coat Hook	PB, CP, SCP
AR531 & AR532	Wardrobe Hook (Single or Double)	PB, CP, SCP
AR522B	305 x 100mm Sprung Flap Victorian Letter Plate	PB, Brass PVD, CP, SCP
AR521A & AR522A	255mm x 75mm Sprung Flap Georgian or Victorian Letter Plate	PB, Brass PVD, CP, SCP
AR536	300 x 75mm Internal Letter Tidy	PB, Brass PVD, CP, SCP
AR428A or AR428B	19 x 152mm or 203mm Flush Bolt	PB
AR421A, B or C	35 x 150mm, 225mm or 300mm Slide Bolt	PB, CP, SCP
AR424A, B, H or I	75 x 305mm, 350mm, 450mm or 650mm Square Corner Finger Plate	PB, CP, SCP
AR424D	75 x 350mm Finger Plate Square Corner Engraved "PUSH"	PB, CP, SCP



AR212



AR135



AR224B



AR326



AR427D



AR406

ACCESSORIES CONTINUED

CODE	DESCRIPTION	FINISHES
AR424G	75 x 305mm Georgian Square Corner Finger Plate	PB, CP, SCP
AR425	Kick Plates (Cut to Order)	PB
AR540	75mm Face Fix Numerals/Letters 0 to 9 & A to D	PB, Brass PVD, CP, SCP
AR526-6 or 8	150mm or 200mm Victorian Urn Type Door Knocker	PB, Brass PVD, CP, SCP
AR525-6 or 8	150mm or 200mm Georgian Urn Type Door Knocker	PB, Brass PVD, CP, SCP
AR544 or AR545	35 x 76mm Victorian or Georgian Bell Push	PB, Brass PVD, CP, SCP
AR546 or AR547	57mm Diameter Victorian or Georgian Bell Push	PB, Brass PVD, CP, SCP
AR549B or AR549C	100mm or 150mm Silent Pattern Cabin Hook	PB, Brass PVD, CP, SCP



RAL COLOUR ACCESSORIES

CODE	DESCRIPTION	FINISHES
AR614	75mm Secret Fix Door Stop	11 RAL Colours
AR612	32mm Diameter Floor/Wall Mounted Door Stop	11 RAL Colours
AR613	52mm Diameter Floor/Wall Mounted Door Stop	11 RAL Colours
AR606	Cylinder Pull for Rim, Euro or Oval Cylinder	11 RAL Colours
AR617A	164mm Face Fix Hat & Coat Hook	11 RAL Colours
AR617B	143mm Concealed Fix Hat & Coat Hook	11 RAL Colours
AR618	60mm Face Fix Wardrobe Hook	11 RAL Colours
AR619	73mm Large Wardrobe Hook	11 RAL Colours
AR610C	19 x 200mm Flush Bolt	11 RAL Colours
AR610A or B	150mm or 200mm Surface Door Bolt	11 RAL Colours



SIGNAGE

CODE	DESCRIPTION	FINISHES
AR902	"Fire door keep shut" 76mm Diameter Sign	SAA, SSS, PSS, PB
AR905	"Fire door keep shut" 80mm Square Sign	SAA, SSS, PSS, PB
AR916A	"Fire door keep shut" 80mm Square Sign	Enamelled Aluminium, Rigid Plastic, Vinyl Self Adhesive
AR901	"Fire door keep locked" 76mm Diameter Sign	SAA, SSS, PSS, PB
AR906	"Fire door keep locked" 80mm Square Sign	SAA, SSS, PSS, PB
AR916B	"Fire door keep locked" 80mm Square Sign	Enamelled Aluminium, Rigid Plastic, Vinyl Self Adhesive
AR916F	"Automatic fire door keep clear" 80mm Square Sign	Enamelled Aluminium, Rigid Plastic, Vinyl Self Adhesive
AR903D	76mm Diameter Disabled WC sign	SAA, SSS, PSS, PB
AR903F	76mm Diameter Female WC Sign	SAA, SSS, PSS, PB
AR903M	76mm Diameter Male WC Sign	SAA, SSS, PSS, PB
AR903U	76mm Diameter Unisex WC Sign	SAA, SSS, PSS, PB
AR607D	100 x 150mm Rectangular Disabled WC Sign	11 RAL Colours
AR607F	100 x 150mm Rectangular Female WC Sign	11 RAL Colours
AR607M	100 x 150mm Rectangular Male WC Sign	11 RAL Colours
AR607ID	80 x 150mm International Disabled WC Sign	11 RAL Colours
AR607IF	80 x 150mm International Female WC Sign	11 RAL Colours
AR607IM	80 x 150mm International Male WC Sign	11 RAL Colours



A guide to finishes is available on page 94.

DOOR CLOSERS

AR8300 Series Size 2 to 5 Door Closer

High efficiency door closer which meets the required maximum opening forces for door controls recommended in Approved Document "M" (independently type tested under laboratory conditions).

- Suitable for most commercial applications and public buildings
- Backcheck optional
- Delayed action optional
- Slide arm optional
- Stand open arm (Hold Open) optional
- Designer cover
- Matching arms optional
- Available in all finishes



AR8300

Avanté 2 Series Size 2 to 5 Door Closer

High efficiency door closer which meets the required maximum opening forces for door controls recommended in Approved Document "M" (independently type tested under laboratory conditions).

- Suitable for most commercial applications and public buildings
- Backcheck standard
- Delayed action optional
- Slide arm optional
- Stand open arm (Hold Open) optional
- Matching arms optional
- Available in all finishes



AVANTÉ 2 SERIES

AR1998 Series Size 3 to 4 Electromagnetic Door Closer (24v)

Elegant solution for Inclusive Design. This electromagnetic closer will hold the door open until activated by the fire alarm. Can also be set up in "swing free" mode for inward opening doors. Suitable for most commercial applications and public buildings.

- RADIUS or designer cover
- Available in all finishes
- Transformer required



AR1998

AR3500 Series Size 2 to 4 Door Closer

Fully featured door closer offering backcheck and delayed action in one unit. With a choice of three covers and matching arms the AR3500 is the top selling door closer for high traffic commercial specifications.

- Backcheck standard
- Delayed action standard
- Stand open arm (Hold Open) optional
- Matching arms optional
- RADIUS, rectangular or designer cover
- Available in all finishes



AR3500

AR7200/AR7500 Series Size 2 to 4 Door Closer

Very popular good looking door closer. Offered with a choice of slide cover or fully enclosed Mini Designer cover.

- Suitable for medium to heavy duty commercial applications
- Backcheck optional
- Designer cover (on AR7500 only)
- Matching arms optional (std on AR7200)
- Finishes SE, GE, PSS, SSS, PB (all finishes on AR7500)



AR7200

AR6800/AR6900 Series Size 3 Door Closer

Very popular entry level door closer. Offered with or without the fully enclosed Mini Designer cover.

- Suitable for medium duty commercial applications
- Designer cover (on AR6900 only)
- Matching arms optional (std on AR6800)
- Finishes SE & GE (all finishes on AR6900)



AR6800

AR5300/AR5400 Series Size 3 Slide Arm Door Closer

Highly specified slide arm closer suitable for schools etc where a projecting arm can lead to vandalism. Offered with or without a fully enclosed designer cover.

- Matching arms optional
- Designer cover (on AR5400 only)
- Finishes SE & GE (all finishes on AR5400)



AR5400

AR800 Size 1 to 4 Floor Spring

An adjustable power unit which incorporates a proven cam action roller system combining smooth performance with reliability.

- Backcheck
- Finishes: PB, SSS & PSS

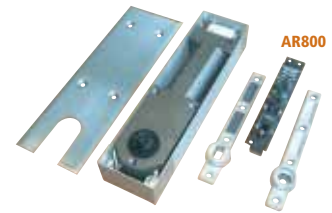

AR800EM Size 4 Electromagnetic Floor Spring (24v)

An adjustable power unit which incorporates a proven cam action roller system combining smooth performance with reliability.

- Backcheck (transformer required)
- Finishes PB, SSS & PSS



AR1990 Concealed Chain Door Closer

- Available in PB, EB, CP and SCP
- Tested to BS EN1634-1 (30 minutes)

AR-RT1991 Hercules Domestic Door Closer

- Available in White, Polished Brass and SSS



AR226 Door Selector / Door Coordinator Mk1

- Tested to BS EN1158
- Available in SAA and GAA

AR226/Mk2 Door Selector / Door

- Coordinator Mk2
- Tested to BS EN1158 and BS EN1634-1 and suitable for 2 hour fire doors
- Available in SE, GE, PB, SSS and PSS



EMERGENCY EXIT HARDWARE

A guide to finishes is available on page 94.

AR880 Single Panic Bolt

Performance Tested to BS EN1125

Fire Tested to BS EN1634-1

CE Marked

Max. Door Size 1220mm x 2440mm

Finishes: SE, GE, BL, PSS, SSS, PB & 11 Ral Colours

Important Note: Suitable for public buildings



AR882 Reversible Panic Latch

Performance Tested to BS EN1125

Fire Tested to BS EN1634-1

CE Marked

Max. Door Size 1220mm

Finishes: SE, GE, BL, PSS, SSS, PB & 11 Ral Colours

Important Note: Suitable for public buildings



AR883 Reversible Push Pad

Performance Tested to BS EN179

Fire Tested to BS EN1634-1

CE Marked

Finishes: SE, GE, BL, PSS, SSS, PB & 11 Ral Colours

Important Note: NOT suitable for public buildings



AR884 Push Pad Single Panic Bolt

Performance Tested to BS EN179

Fire Tested to BS EN1634-1

CE Marked

Max. Door Size 2440mm high

Finishes: SE, GE, BL, PSS, SSS, PB & 11 Ral Colours

Important Note: NOT suitable for public buildings



AR888 Combination Unit for Double Rebated Doors

Performance Tested to BS EN1125

Fire Tested to BS EN1634-1

CE Marked

Max. Door Size 2440mm x 2440mm

Finishes: SE, GE, BL, PSS, SSS, PB & 11 Ral Colours

Important Note: Suitable for public buildings



AR885 External Unlocking Attachment Lever Type

Available with or without cylinder

Finishes: Silver, Gold & Black



AR885K External Unlocking Attachment Knob Type

Available with or without cylinder

Finishes: Silver, Gold & Black

LOCKS AND CYLINDERS

Tubular Mortice Latch AR/M-719

Available in 63mm & 75mm

Finishes: Polished Brass, Nickel Plated & Polished Stainless Steel

Square and Radiused Forend



Heavy Duty Tubular Mortice Latch AR/A-819

Guided Latchbolt

Available in 63mm, 76mm, 100mm & 128mm

Finishes: Satin Chrome, Polished Brass & Polished Stainless Steel



Flat Mortice Latch AR/M-720

Available in 63mm, 75mm & 100mm

Finishes: Polished Brass, Satin Chrome & Polished Stainless Steel

Square and Radiused Forend

Rebate sets are available in 13mm or 25mm and matching finishes



Square Case Mortice Latch AR/M-700M

Available in 63mm, 75mm & 100mm

Finishes: Polished Brass, Satin Chrome & Polished Stainless Steel

Rebate sets are available in 13mm or 25mm and matching finishes



Architectural Plus Square Case Mortice Latch AR/A-800

Guided Latchbolt

Available in 63mm, 75mm & 100mm

Finishes: Polished Brass, Satin Chrome & Polished Stainless Steel

Rebate sets are available in 13mm or 25mm and matching finishes



Upright Mortice Latch AR/M-707

Available in 63mm & 75mm

Finishes: Polished Brass, Satin Chrome & Polished Stainless Steel

Rebate sets are available in 13mm or 25mm and matching finishes



Architectural Plus Upright Mortice Latch AR/A-807

Guided Latchbolt

Available in 63mm & 75mm

Finishes: Polished Brass, Satin Chrome & Polished Stainless Steel

Rebate sets are available in 13mm or 25mm and matching finishes



3 Lever Mortice Sashlock AR/M-701

Available in 63mm & 75mm

Finishes: Satin Chrome & Polished Brass

Rebate sets are available in 13mm or 25mm and matching finishes



3 Lever Mortice Deadlock AR/M-702

Available in 63mm & 75mm

Finishes: Satin Chrome & Polished Brass

Rebate sets are available in 13mm or 25mm and matching finishes



5 Lever Mortice Sashlock AR/M-714

Available in 63mm & 75mm

Finishes: Satin Chrome, Polished Brass & Polished Stainless Steel

Rebate sets are available in 13mm or 25mm and matching finishes



5 Lever Mortice Deadlock AR/M-715

Available in 63mm & 75mm

Finishes: Satin Chrome, Polished Brass & Polished Stainless Steel

Rebate sets are available in 13mm or 25mm and matching finishes



Euro Profile Mortice Sashlock Case AR/M-704

Available in 63mm & 75mm

Finishes: Polished Brass, Satin Chrome & Polished Stainless Steel

Square & Radiused Forend

Box Striking Plates available

Rebate sets are available in 13mm or 25mm and matching finishes



Euro Profile Mortice Deadlock Case AR/M-706

Available in 63mm & 75mm

Finishes: Polished Brass, Satin Chrome & Polished Stainless Steel

Square & Radiused Forend

Box Striking Plates available

Rebate sets are available in 13mm or 25mm and matching finishes



Oval Profile Mortice Sashlock Case AR/M-703

Available in 63mm & 75mm

Finishes: Polished Brass, Satin Chrome & Polished Stainless Steel

Square & Radiused Forend

Box Striking Plates available

Rebate sets are available in 13mm or 25mm and matching finishes



Bathroom Mortice Lock (5mm or 8mm Follower) AR/M-723

Available in 63mm & 75mm

Finishes: Polished Brass, Satin Chrome & Polished Stainless Steel

Square & Radiused Forend

Box Striking Plates available

Rebate sets are available in 13mm or 25mm and matching finishes



AR/M-723

Traditional Cylinder Rim Nightlatch AR/M-735

90mm Case with 60mm Backset

Finishes: Champagne Case with Polished Brass Cylinder

Available case only (minus cylinder)



AR/M-735

Narrow Stile Deadlocking Cylinder Rim Nightlatch AR/M-745

60mm Case with 40mm Backset

Finishes: Silver or Brass Case with Polished Brass or Satin Chrome Cylinder

Available case only (minus cylinder)



AR/M-745

Square Case Bathroom Deadbolt (5mm Follower) AR/M-731

Available in 67mm, 76mm & 100mm

Finishes: Satin Chrome & Polished Brass



AR/M-731

Wide Stile Deadlocking Cylinder Rim Nightlatch AR/M-740

90mm Case with 60mm Backset

Finishes: Silver or Brass Case with Polished Brass or Satin Chrome Cylinder

Available case only (minus cylinder)

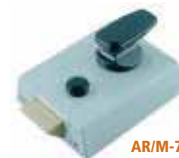

AR/M-740

Rim Cylinder AR/M-770

Finishes: Polished Brass & Satin Chrome

Keyed to Differ or Keyed Alike



AR/M-770

CES CYLINDERS

Available in 5 pin standard differs (offering random key combinations).

Keyed Alike or Master Keyed. These could be either 5 pin systems with blanks available or restricted section 6 pin systems for higher security applications.

DESCRIPTION	CODE	SIZES (MM)	FINISHES
CES Euro Profile Cylinder & Turn	CES-815	63, 71, 81	Nickel Plated or Polished Brass
CES Oval Profile Cylinder & Turn	CES-715	63, 71, 81	Nickel Plated or Polished Brass
CES Euro Profile Double Cylinder	CES-810	63, 71, 81	Nickel Plated or Polished Brass
CES Oval Profile Double Cylinder	CES-710	63, 71, 81	Nickel Plated or Polished Brass
CES Euro Profile Single Cylinder	CES-851	40.5, 45.5, 50.5	Nickel Plate or Polished Brass
CES Oval Profile Single Cylinder	CES-751	40.5, 45.5, 50.5	Nickel Plate or Polished Brass
CES Rim Cylinder	CES-30		Nickel Plate & Polished Brass
CES Round Mortice Threaded Cylinder	CES-5875		Nickel Plate & Polished Brass
CES Padlock	CES-215N	58	Brass



CES-715



CES-810

The ARNONE® 6 pin convenience suite offers an 'off-the-shelf' pre-assembled master keyed system.

The suite consists of a master key controlling 200 straight differs.

No sub-suites or common cylinders available.

DESCRIPTION	CODE	SIZES (MM)	FINISHES
ARRONE® Euro Profile Cylinder & Turn	AR/M-781	70	Satin Chrome or Polished Brass
ARRONE® Euro Profile Double Cylinder	AR/M-780	70	Satin Chrome or Polished Brass
ARRONE® Euro Profile Single Cylinder	AR/M-782	50	Satin Chrome or Polished Brass
ARRONE® Oval Profile Cylinder & Turn	AR/M-784	70	Satin Chrome or Polished Brass
ARRONE® Oval Profile Double Cylinder	AR/M-783	70	Satin Chrome or Polished Brass
ARRONE® Oval Profile Single Cylinder	AR/M-785	50	Satin Chrome or Polished Brass
ARRONE® Rim Cylinder	AR/M-786		Satin Chrome and Polished Brass



AR/M-780



AR/M-784

HINGES

SIZES	DESCRIPTION	FINISHES
100 x 75 x 3mm (4" x 3" x 3mm)	2 Ball Bearing Square Corner Stainless Steel Hinges	AR8180 SSS, AR9290 PSS, AR7070 Brass PVD
100 x 75 x 3mm (4" x 3" x 3mm)	2 Ball Bearing Square Corner Dog Bolt Security Stainless Steel Hinges	AR8186 SSS, AR9296 PSS, AR7076 Brass PVD
100 x 75 x 2.25mm	AR628B (1838 Pattern) Butt Hinge	11 RAL Colours

AR8180



SHELVING SOLUTIONS

Easy to install, use and re-arrange. They fit into a variety of settings where demands of versatility, functional storage and space economy are particularly high.

Traditional Double Slot Shelving System Uprights

CODE	SIZE (MM)	FINISH
AR-V032-WH	316	White
AR-V032-SE	316	Platinum
AR-V064-WH	636	White
AR-V064-SE	636	Platinum
AR-V096-WH	956	White
AR-V096-SE	956	Platinum
AR-V128-WH	1276	White
AR-V128-SE	1276	Platinum
AR-V160-WH	1596	White
AR-V160-SE	1596	Platinum
AR-V192-WH	1916	White
AR-V192-SE	1916	Platinum
AR-V224-WH	2236	White
AR-V224-SE	2236	Platinum
AR-V240-WH	2396	White
AR-V240-SE	2396	Platinum



Traditional Double Slot Shelving System Brackets

CODE	SIZE (MM)	FINISH
AR-K12-WH	120	White
AR-K12-SE	120	Platinum
AR-K17-WH	170	White
AR-K17-SE	170	Platinum
AR-K22-WH	220	White
AR-K22-SE	220	Platinum
AR-K27-WH	270	White
AR-K27-SE	270	Platinum
AR-K32-WH	320	White
AR-K32-SE	320	Platinum
AR-K37-WH	370	White
AR-K37-SE	370	Platinum
AR-K47-WH	470	White
AR-K47-SE	470	Platinum
AR-KF57-WH	570	White
AR-KF57-SE	570	Platinum

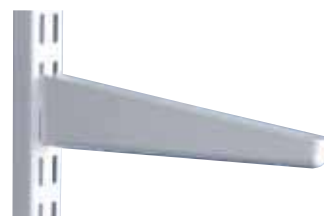

Traditional Double Slot Shelving System Accessories

CODE	DESCRIPTION	FINISH
AR-S420-WH	200mm Sprung Book Supports	White
AR-S420-SE	200mm Sprung Book Supports	Platinum
AR-F800	Wallbar Fixing Kit	
AR-F801	Shelf Fixing Kit	
AR-FVK	Shelf Connecting Kit	



Hang System Top Track

CODE	SIZE (MM)	FINISH
AR-T420110-WH	1020	White
AR-T420180-SE	1020	Platinum
AR-T422010-WH	2000	White
AR-T422080-SE	2000	Platinum

Hang System Hanging Wallbars

CODE	SIZE (MM)	FINISH
AR-V426310-WH	1200	White
AR-V426380-SE	1200	Platinum
AR-V426410-WH	2000	White
AR-V426480-SE	2000	Platinum



Ventilated Shelf Brackets

CODE	SIZE (MM)	FINISH
AR-K410310-WH	300	White
AR-K410380-SE	300	Platinum
AR-K410410-WH	400	White
AR-K410480-SE	400	Platinum



Ventilated Shelves

CODE	SIZE (MM)	FINISH
AR-VS450410-WH	900 x 300	White
AR-VS450480-SE	900 x 300	Platinum
AR-VS450510-WH	900 x 400	White
AR-VS450580-SE	900 x 400	Platinum
AR-VS450610-WH	1830 x 300	White
AR-VS450680-SE	1830 x 300	Platinum
AR-VS450710-WH	1830 x 400	White
AR-VS450780-SE	1830 x 400	Platinum

Clothes Rail

CODE	SIZE (MM)	FINISH
AR-R620913-WH	900	White
AR-R621813-WH	1800	White
AR-R620903-CH	900	Chrome
AR-R621803-CH	1800	Chrome

Accessories

CODE	DESCRIPTION	FINISH
AR-F800	Top Track Fixing Kit	
AR-R470110-WH	Rail Holder	White
AR-R470180-SE	Rail Holder	Platinum
AR-R623914-WH	End Caps	White
AR-R623924-BL	End Caps	Black



ACCESS CONTROL

AR/E-KIT001 Electronic Door Entry Kit 1

Stand-alone vandal resistant kit with keypad and electric release.

Kit includes:

AR/E-C6010	Vandal Resistant Keypad
AR/E-R2022	Rim/Mortice Electric Release 12v DC
AR/E-P4010	12v DC 2 Amp Power Supply with Battery Charger
AR/E-C6021	Egress Button

AR/E-KIT002 Electronic Door Entry Kit 2

Stand-alone kit with proximity reader and electric release.

Kit includes:

AR/E-C6016	Programmable Proximity Reader
AR/E-R2022	Rim/Mortice Electric Release 12v DC
AR/E-P4010	12v DC 2 Amp Power Supply with Battery Charger
AR/E-C6021	Egress Button
AR/E-C6012	Proximity Reader
AR/E-C6015	Pack of 10 Key Cards

AR/E-KIT003 Electronic Door Entry Kit 3

Stand-alone vandal resistant kit with keypad and magnet.

Kit includes:

AR/E-C6010	Vandal Resistant Keypad
AR/E-M7010	Slimline magnet 12/24v DC
AR/E-P4010	12v DC 2 Amp Power Supply with Battery Charger
AR/E-C6021	Egress Button
AR/E-M7013	"L" Bracket
AR/E-C6022	Push Button Emergency Exit

AR/E-KIT004 Electronic Door Entry Kit 4

Stand-alone kit with proximity reader and magnet.

Kit includes:

AR/E-C6016	Programmable Proximity Reader
AR/E-C6012	Proximity Reader
AR/E-C6015	Pack of 10 Key Cards
AR/E-M7010	Slimline magnet 12/24v DC
AR/E-P4010	12v DC 2 Amp Power Supply with Battery Charger
AR/E-C6021	Egress Button
AR/E-M7013	"L" Bracket
AR/E-C6022	Push Button Emergency Exit



AR/E-3K1S Videx 1 Way Audio Surface Door Kit

- Wall mountable telephone
- 3 level call tone volume
- Outdoor station with built in relay for electric lock
- 3 wires plus call wire to handset



AR/E-3K2S Videx 2 Way Audio Surface Door Kit

- Wall mountable telephones
- 3 level call tone volume
- Outdoor station with built in relay for electric lock
- 3 wires plus call wire to handset



AR/E-DK1 Videx 1 Way Audio/Keypad Door Kit

- Combined audio door entry kit with integral keypad
- Wall mountable telephone
- 3 level call tone volume
- Outdoor station with built in relay for electric lock
- 3 wires plus call wire to handset



AR/E-SLK1 Videx 1 Way Slimline Audio Door Kit

- Wall mountable telephone
- 3 level call tone volume
- Outdoor station with built in relay for electric lock
- 3 wires plus call wire to handset



LOC-LST01 LOCCA Sure-Touch

- The Locca Sure-Touch is Access Control made easy.
- The kit comprises of a receiver, to operate an existing electric strike, a power supply, 2 remote keys and a Master remote key
- The remote keys signal the receiver from up to 50 metres to release the strike and allow access
- No electrical expertise required (transformer plug enclosed)
- Pre-programmed and pre-wired for ease of installation



AR/E-SD880 SRS Video Door Entry Kit

- Calls up to three monitors. Extra monitors available.



Cutting tools and accessories available from pages 32, 33, 36 of the Power Tools and Accessories section.

